



FY 2020 County Transportation Plan

Chambers County



Date Approved by the Chambers County Commission: August 26, 2019

Date Amended by the Chambers County Commission: NA

Map Index	Project No.	Road Name/Number	Begin		End		Project Details				Total Project Estimated Cost	Estimated Amount Planned To Be Utilized Under Competitive Bid	Estimated Amount Planned To Be Utilized Under Public Works	County Rebuild Alabama Funds or Federal Aid Exchange Funds (List fund type separately for projects involving both CRAFs and FAEFs)	CRAF Amount	FAEF Amount
			Lat.	Long.	Lat.	Long.	Road Improvement Project	Bridge Improvement Project	Project Length (miles)	Description of Work						
										Estimated Beginning Balance					\$0.00	\$0.00
										Estimated Annual Revenue					\$492,300.56	\$400,000.00
219	RA-CCP 09-01-20	CR 166	32.9594	85.4059	32.9609	85.4122	X		0.23	Reconstruct, Pave, and Stripe from CR 164 west to End of Pavement	\$40,000.00		\$40,000.00	CRAF	\$40,000.00	
248	RA-CCP 09-02-20	CR 82	32.7833	85.3094	32.7868	85.2997	X		0.40	Resurface from CR 83 East and West to End of Pavement	\$50,000.00		\$50,000.00	CRAF	\$50,000.00	
213	RA-CCP 09-03-20	47th Avenue	32.8278	85.2398	32.8271	85.2357	X		0.20	Reconstruct, Pave, and Stripe from CR 299 west to Dead End	\$30,000.00		\$30,000.00	CRAF	\$30,000.00	
253	RA-CCP 09-05-20	CR 158	32.9702	85.4403	32.9944	85.4327	X		1.82	Reconstruct, Pave, and Stripe from SR 77 north to CR 114	\$115,000.00		\$115,000.00	CRAF	\$115,000.00	
74	RA-CCP 09-04-20	CR 158	32.9944	85.4327	33.0359	85.4380	X		2.91	Reconstruct, Pave, and Stripe from CR 114 north to CR 160	\$180,000.00		\$180,000.00	CRAF	\$180,000.00	
043Z*	RA-CCP 09-06-20	CR 21	32.7336	85.5469	32.7336	85.5469		X	N/A	Reconstruct Bridge 43 over Norfolk Southern RR	\$75,000.00	\$75,000.00		CRAF	\$75,000.00	
157**	CCP 09-15-03	Phillips Road	32.8383	85.2326	32.8308	85.2253	X		0.91	Match for Widening and Traffic Signal Improvements to CR 208 and 299	\$400,000.00		\$400,000.00	FAEF		\$400,000.00
Totals/Page Totals			Total Miles Addressed by CTP (Total Mileage Does Not Include Bridge Projects)						6.47	Total CTP Estimated Costs	\$890,000.00	\$75,000.00	\$815,000.00	Total CRAF/FAEF Remaining Estimated	\$2,300.56	\$0.00

Note: Any amendments to the CTP shall follow the same guidelines and procedures as the original approval process.

Remarks

* Denotes Material Price Only, Project is a Partnership with Norfolk Southern RR. RR is providing the labor and equipment.

** Denotes a portion of the Federal Aid Match. Total county match is \$1.24 million and the total project cost is \$4.48 million.

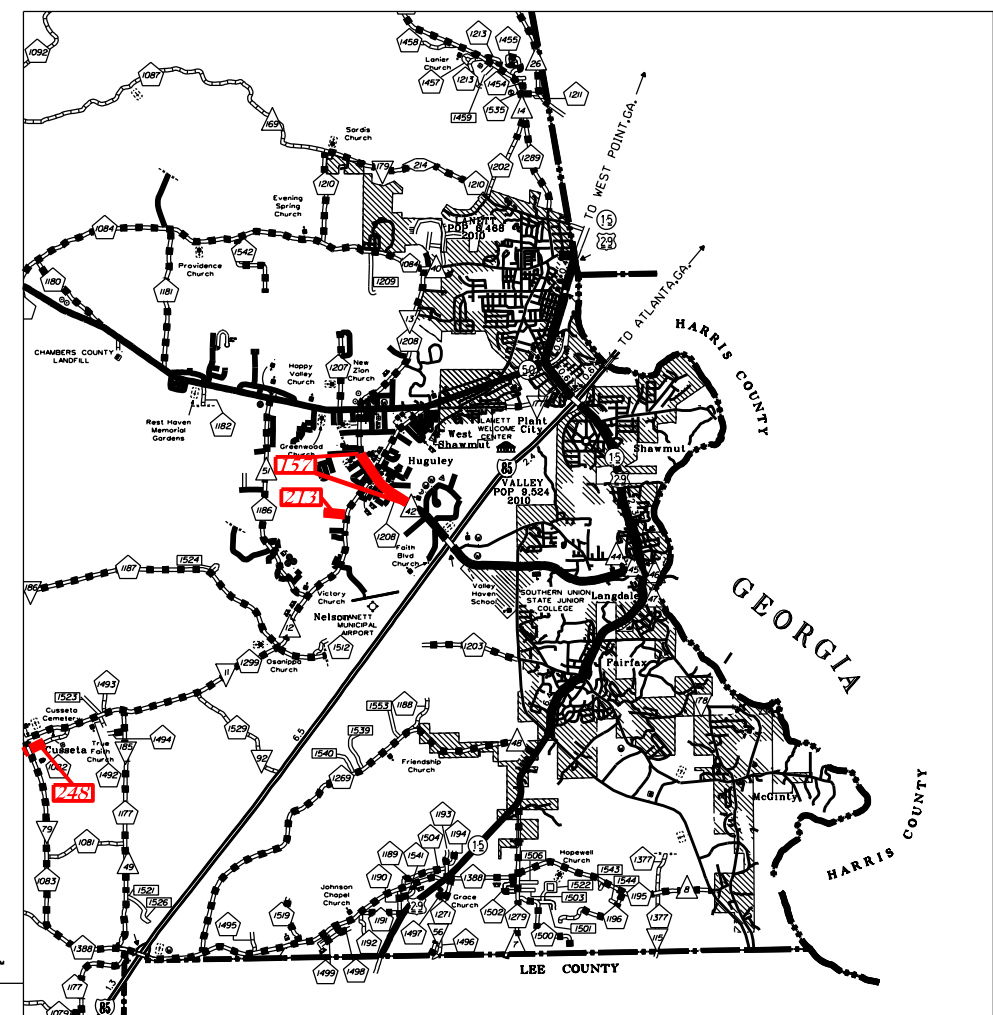
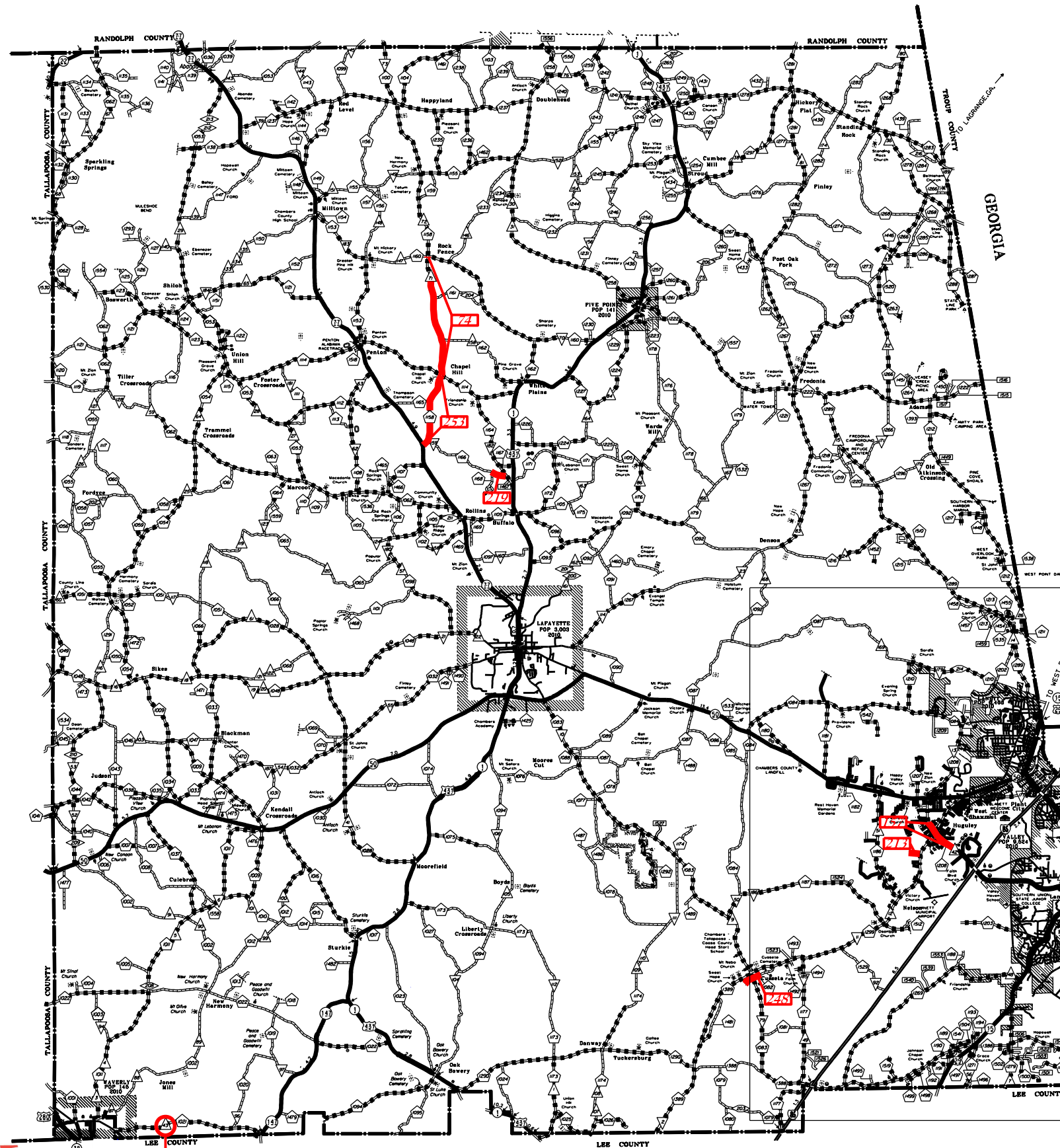

LEGEND

CONSTRUCTION

PLANNED 