



FY 2021 County Transportation Plan

Chambers County



Date Approved by the Chambers County Commission: August 24, 2020

Date Amended by the Chambers County Commission: NA

Map Index	Project No.	Road Name/Number	Begin		End		Project Details				Total Project Estimated Cost	Estimated Amount Planned To Be Utilized Under Competitive Bid	Estimated Amount Planned To Be Utilized Under Public Works	County Rebuild Alabama Funds or Federal Aid Exchange Funds <small>(List fund type separately for projects involving both CRAFs and FAEFs)</small>	CRAF Amount	FAEF Amount
			Lat.	Long.	Lat.	Long.	Road Improvement Project	Bridge Improvement Project	Project Length (miles)	Description of Work						
Estimated Beginning Balance														\$0.00	\$0.00	
Estimated Annual Revenue														\$656,400.75	\$800,000.00	
157**	RA-CCP 09-15-03	Phillips Road	32.8383	85.2326	32.8308	85.2253	X		0.91	Match for Widening, Resurfacing, and Traffic Signal Improvements to CR 208 and 299	\$600,000.00		\$600,000.00	FAEF	\$600,000.00	
208	RA-CCP 09-32-20	CR 75	32.8346	85.4382	32.8307	85.4158	X		1.34	Reconstruct, Pave, and Stripe from US 431 east to pavement end	\$85,000.00		\$85,000.00	CRAF	\$85,000.00	
087z*	RA-CCP 09-50-99	CR 02	32.7379	85.5696	32.7379	85.5696		X	N/A	Replace Bridge 87 on CR 02 over Norfolk Southern RR	\$500,000.00		\$500,000.00	CRAF	\$500,000.00	
083z***	RA-CCP 09-31-20	CR 267	32.9400	85.2856	32.9400	85.2856		X	N/A	Rehab Bridge 83 on CR 267 over Water Works Creek	\$200,000.00		\$200,000.00	FAEF	\$200,000.00	
Totals/Page Totals			Total Miles Addressed by CTP <small>(Total Mileage Does Not Include Bridge Projects)</small>						2.25	Total CTP Estimated Costs	\$1,385,000.00	\$0.00	\$1,385,000.00	Total CRAF/FAEF Remaining Estimated	\$71,400.75	\$0.00

Note: Any amendments to the CTP shall follow the same guidelines and procedures as the original approval process.

Remarks * Denotes a portion of the project cost. The total cost of the bridge replacement is estimated at \$800,000.
 ** Denotes a portion of the project. The total project cost includes \$2.93 million in federal dollars.
 *** Denotes a portion of the project cost. The total cost of the bridge replacement is estimated at \$500,000.

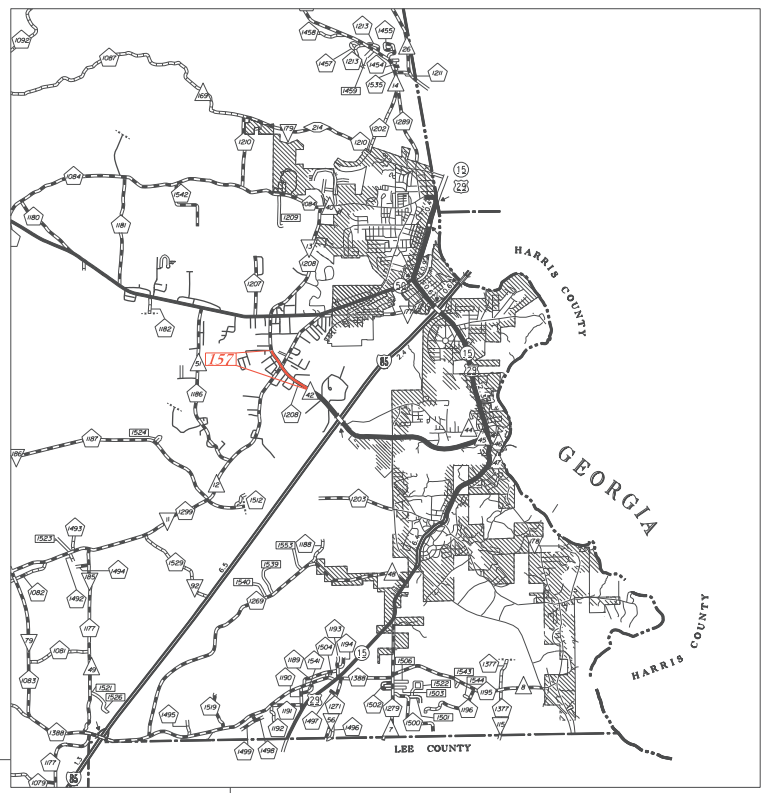
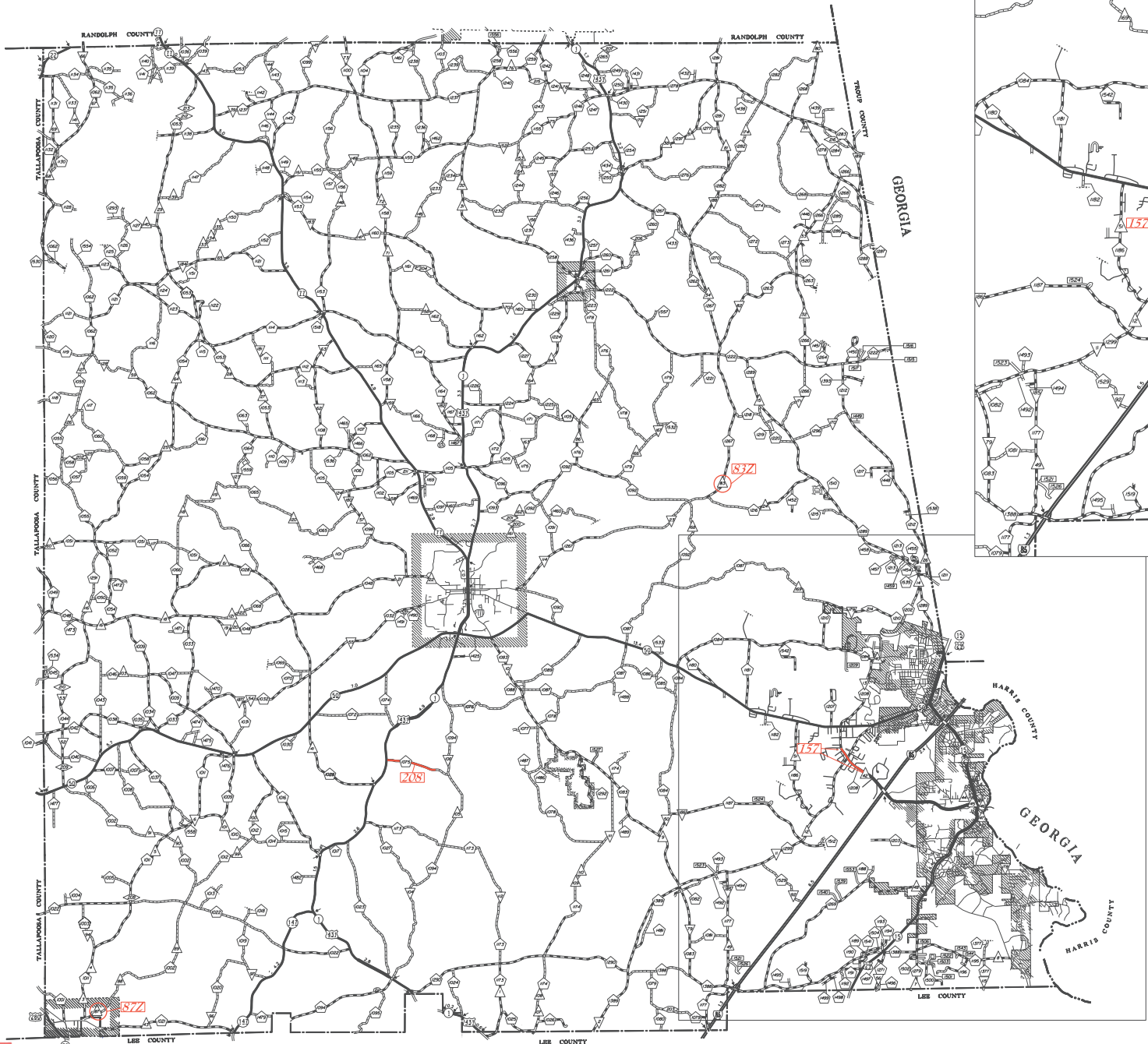

LEGEND

CONSTRUCTION
 PLANNED ○ —