



FY 2024-2027 County Transportation Plan Colbert County

Date Approved by the Colbert County Commission: September 5, 2023



Map Index	Project No.	Road Name/Number	Begin		End		Project Details			Total Project Estimated Cost	Estimated Amount To Be Utilized Under Competitive Bid	Estimated Amount To Be Utilized Under Public Works	County Rebuild Alabama Funds or Federal Aid Exchange Funds (List fund type separately for projects involving both CRAFs and FAEFs)	CRAF Amount	FAEF Amount
			Lat.	Long.	Lat.	Long.	Road Improvement Project	Bridge Improvement Project	Project Length (Miles)						
1A	CCP-17-243-23-1	Winston Springs Rd	34.669161	-87.705476	34.672461	-87.705379	X		0.248	Level and Resurface	\$10,702.19	\$0.00	\$10,702.19	\$10,702.19	\$0.00
									58.961	TOTAL:	\$4,525,404.51	\$0.00	\$4,525,404.51	\$4,525,404.51	-\$25,404.52

COLBERT

COUNTY ROAD DEPARTMENT

TRANSPORTATION PLAN

LOCATION MAP INDEX



PROJECT LOCATION

FOR LOCATIONS
SEE SHEET 1A-1D



COLBERT COUNTY ROAD DEPARTMENT TRANSPORTATION PLAN

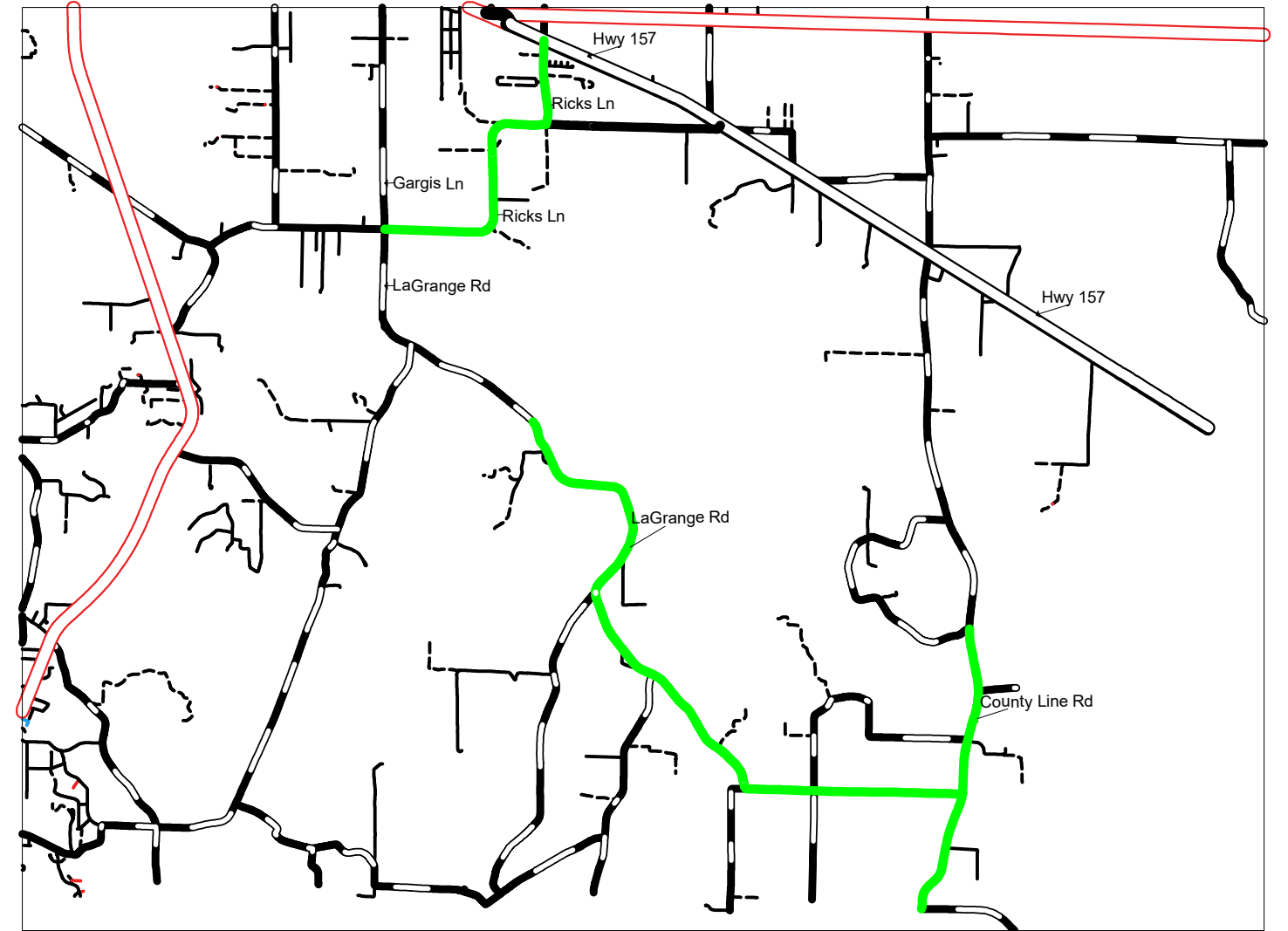
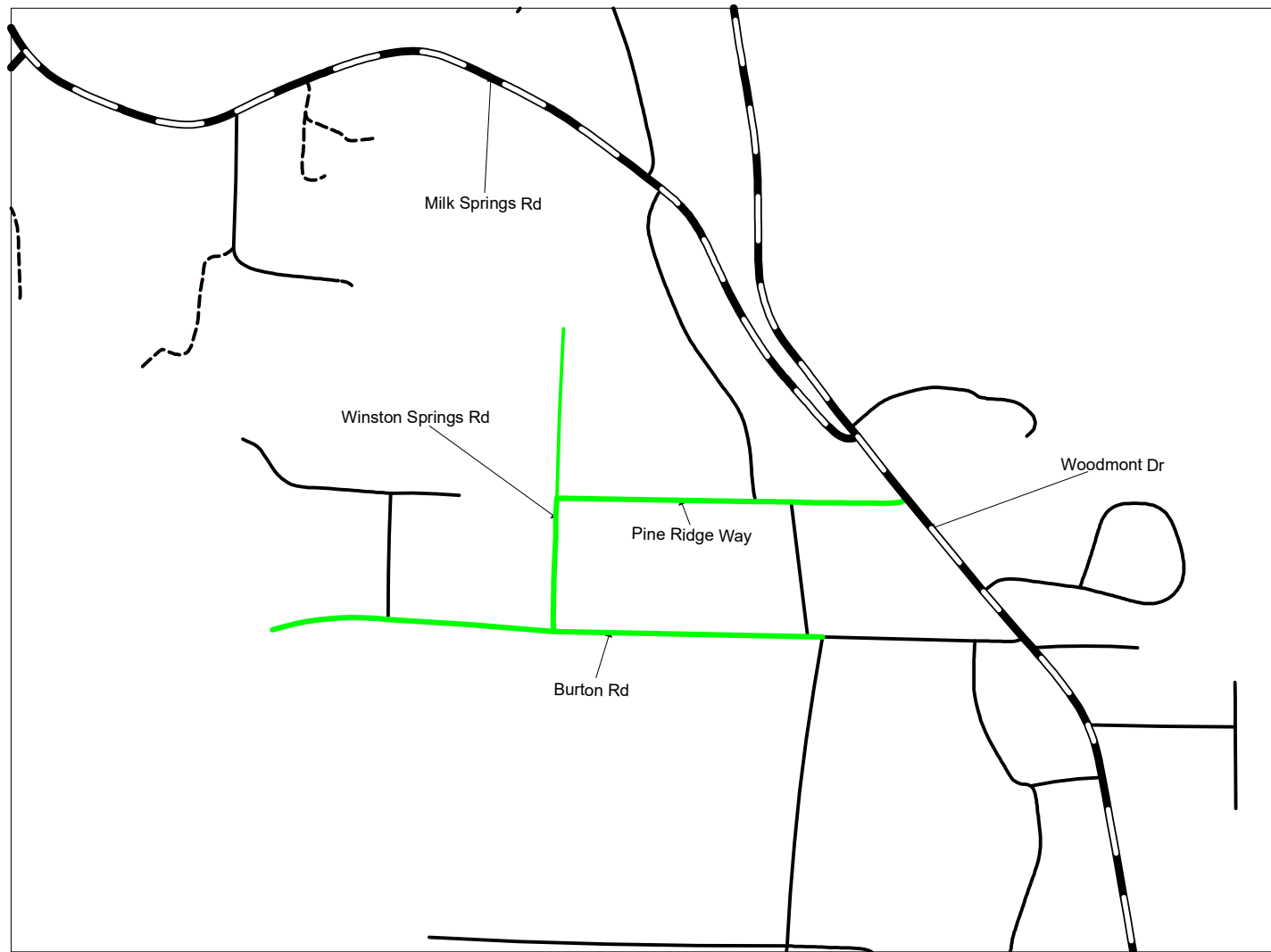

COLBERT COUNTY ROAD DEPARTMENT TRANSPORTATION PLAN

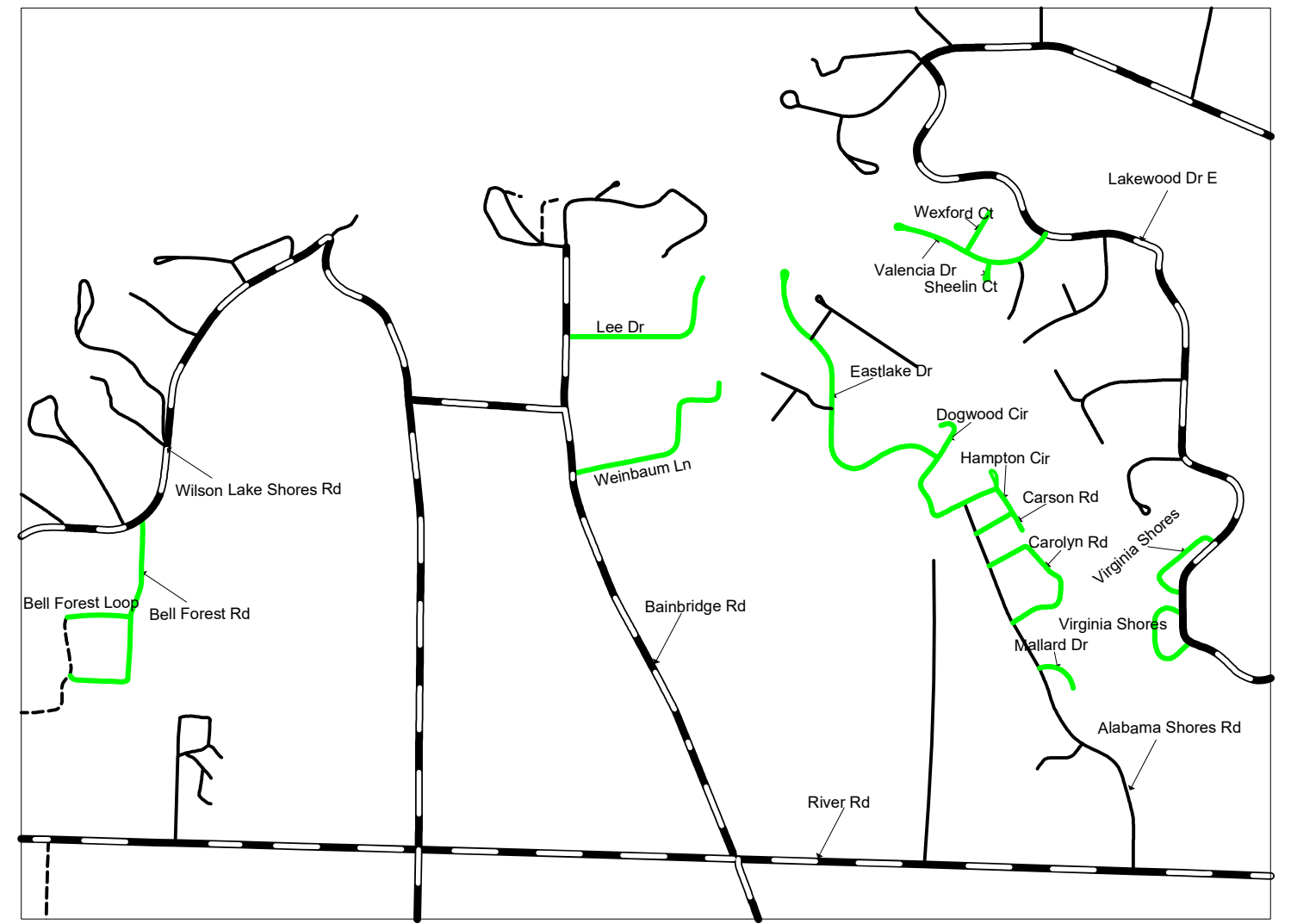
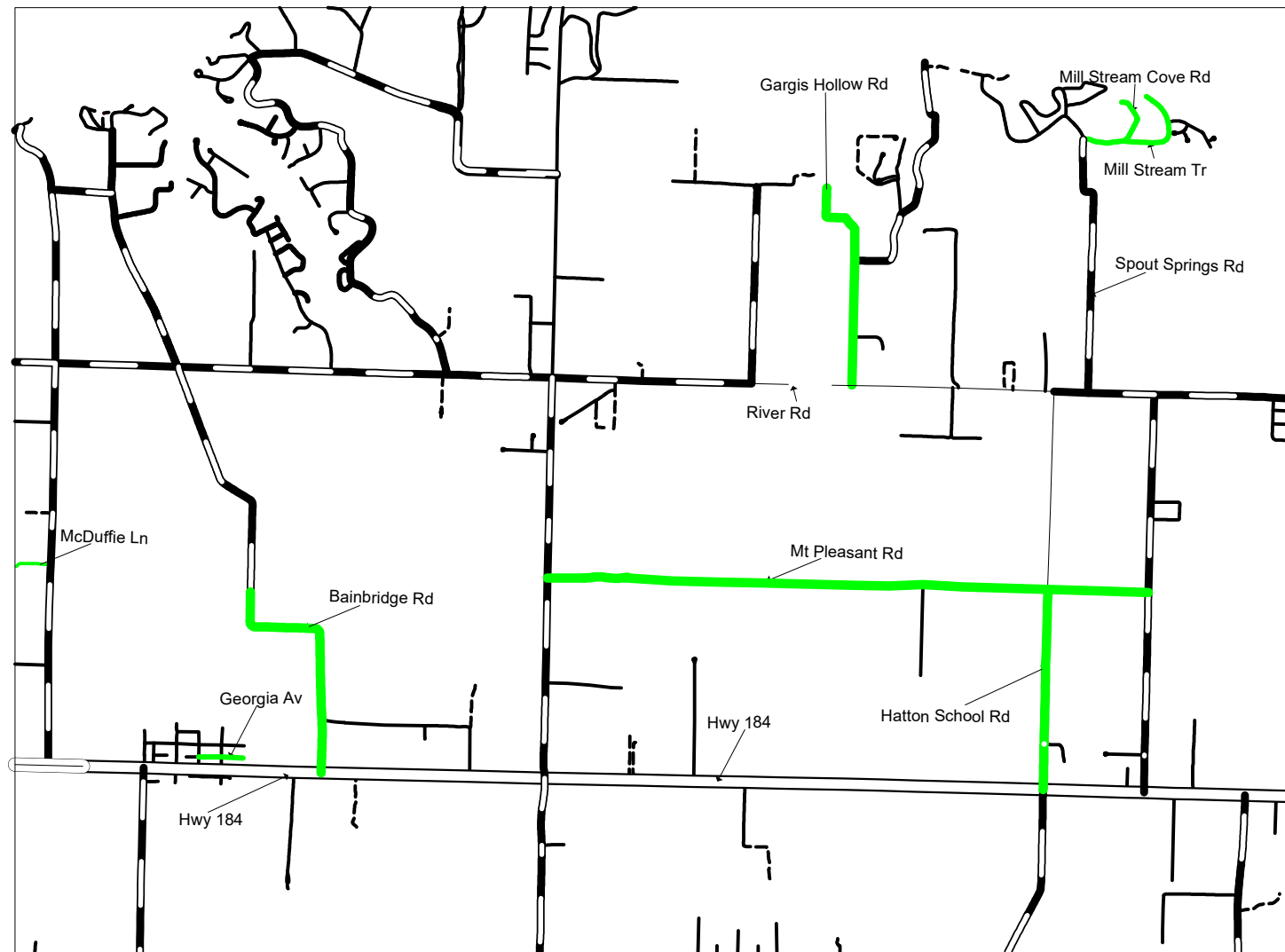

COLBERT COUNTY ROAD DEPARTMENT TRANSPORTATION PLAN

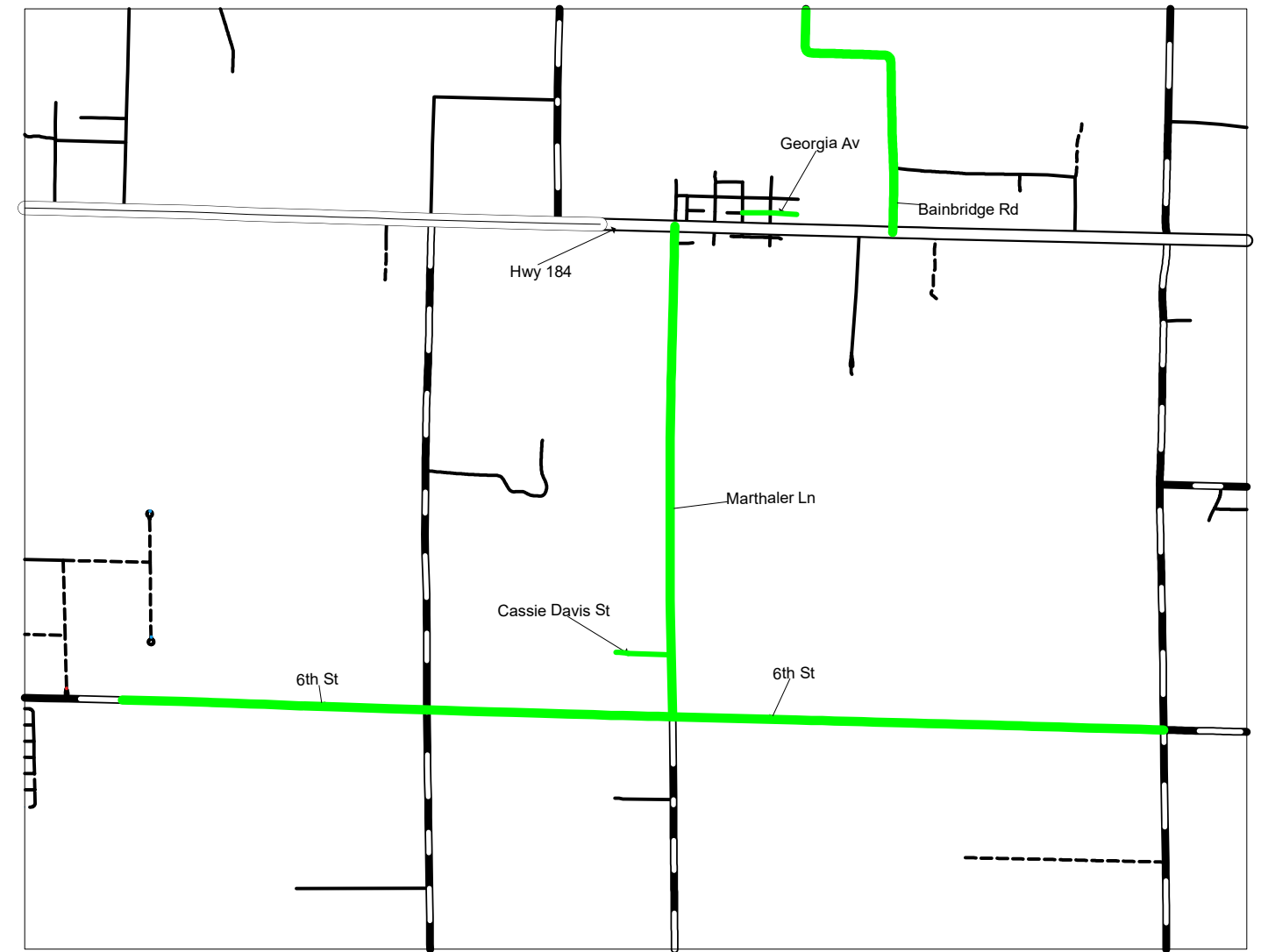
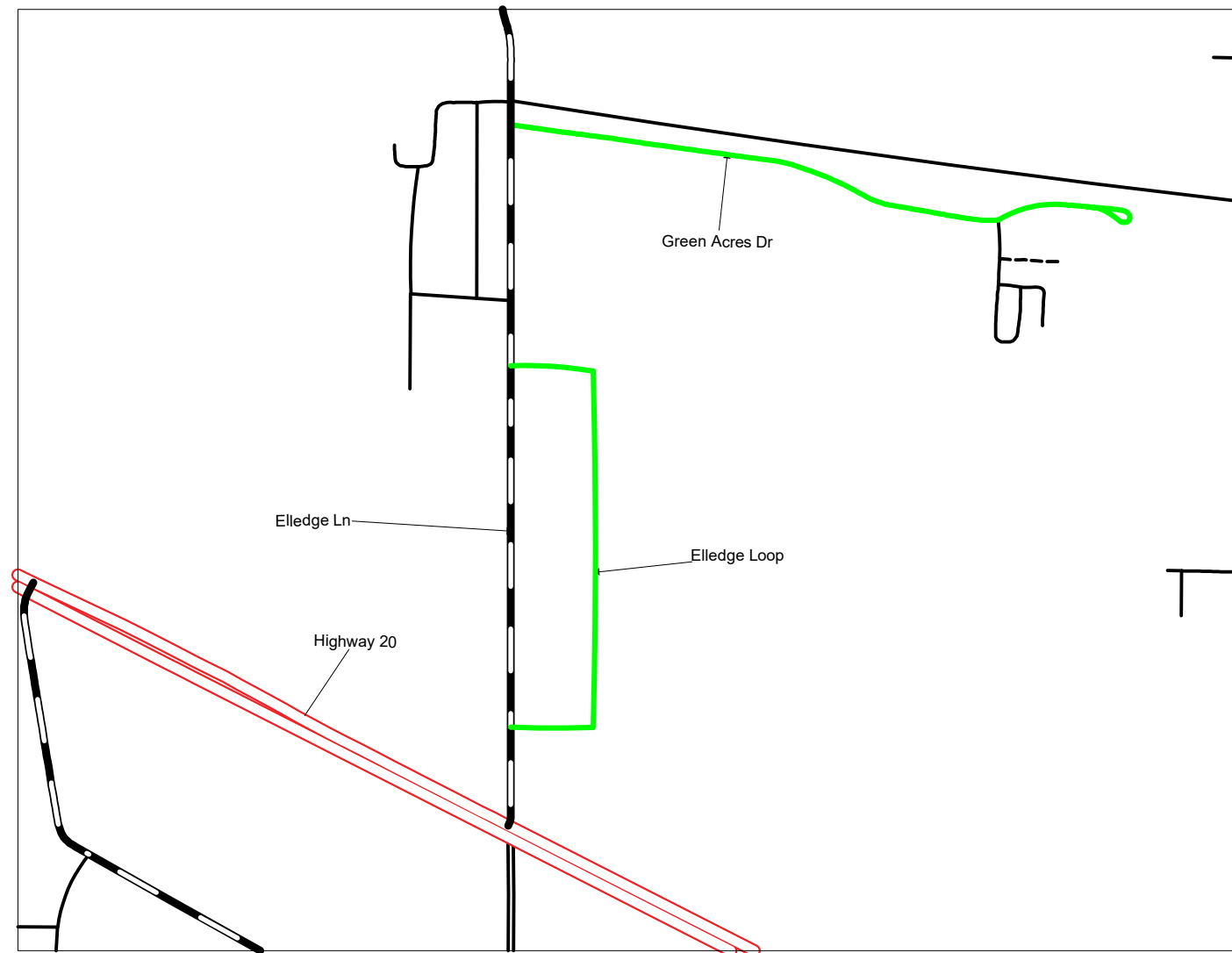

COLBERT COUNTY ROAD DEPARTMENT TRANSPORTATION PLAN

